

PRESSURE SEAL

PS600 Folder/Sealer

High Volume

The PS600 folder/sealer is the ultimate machine for medium to large volume processing. Compact design for a production machine the PS600 is flexible enough to add 2 additional buckle shoots. Paper flow is electronically monitored and the system will automatically shut down in the event of any interruption; Operations can be resumed immediately without disrupting document sequence or count. In addition, an out feed counter is a standard feature, to allow easy calculation of processed documents.



Technical Specification

Processing speed	up to 20,000 forms per hour - variable speed
Monthly Duty Cycle	500,000
Form size	Max. Width 12" x Max. Depth 17"
Fold configurations	V, C, Z, Eccentric Z, Double Parallel and 1-Part 2-Way
Paper weights	Min. 24# - Max. 32# Ledger
Sealer	Integral 4 roller system
Size	49-1/4"H x 45-1/3"L x 24-5/6"W
Weight	750 lbs.
Power	220v to 235v AC 60Hz 1ph 15A
Warranty	90 days
Standard Features	Counter, Conveyor, Cabinet and Sound Covers
Optional Accessories:	Vertical Stacking Outfeed, Center Slitter

4/2019

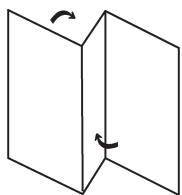

Z-Fold

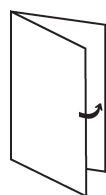

V-Fold

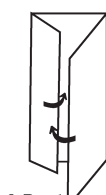

1-Part
2-Way

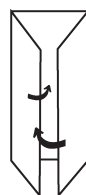

C-Fold



Double
Parallel

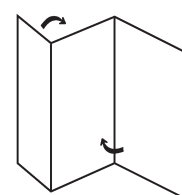

Eccentric
Z-Fold