

### Small Volume

The PS17 - OM2D folds and seals forms at up to 2,500 forms per hour. It can handle a variety of form sizes and folds. Easy to use fold plate settings. Angled seal technology allows for a secure seal. Compact design and quiet operation make it the perfect machine for the small office environment.



OFFICEMATE 2D

#### Technical Specification

|                       |  |
|-----------------------|--|
| Processing speed      | Up to 2,500 forms per hour   |
| Monthly Duty Cycle    | 10,000   |
| Form size             | Max. Width 9-1/4" x Max. Depth 14"   |
| Fold configurations   | V, C, Z, EZ, 1 Prt-2 Way & Double Parallel - 270mm fold plate is standard w/InfoSeal |
| Paper weights         | Up to 28 lb.   |
| Sealer                | 2-roller angled system   |
| Size                  | L 15" x W 13" x H 11"  |
| Weight                | 60 lbs.  |
| Power                 | 120V/60Hz  |
| Warranty              | 90 days  |
| Standard Features     | Easy to use fold plate settings  |
| Optional Accessories: | Cabinet with Storage, Installation   |

4/2019

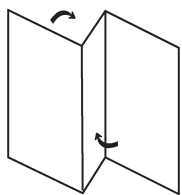

Z-Fold

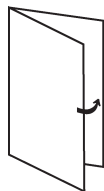

V-Fold



1-Part  
2-Way



C-Fold



Double  
Parallel

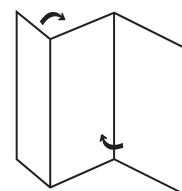

Eccentric  
Z-Fold